

Office Park At A New Satellite Town of Istanbul, 2003

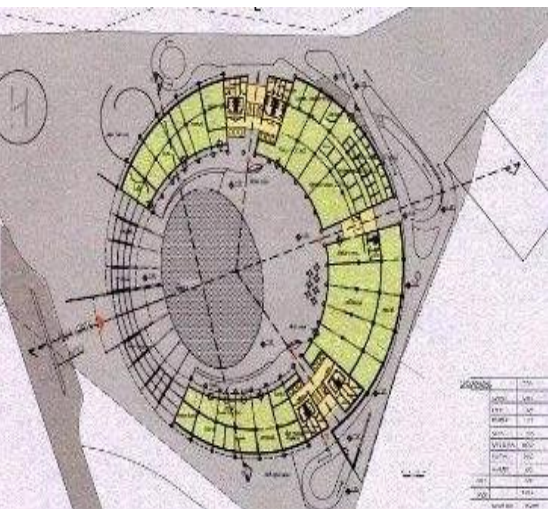
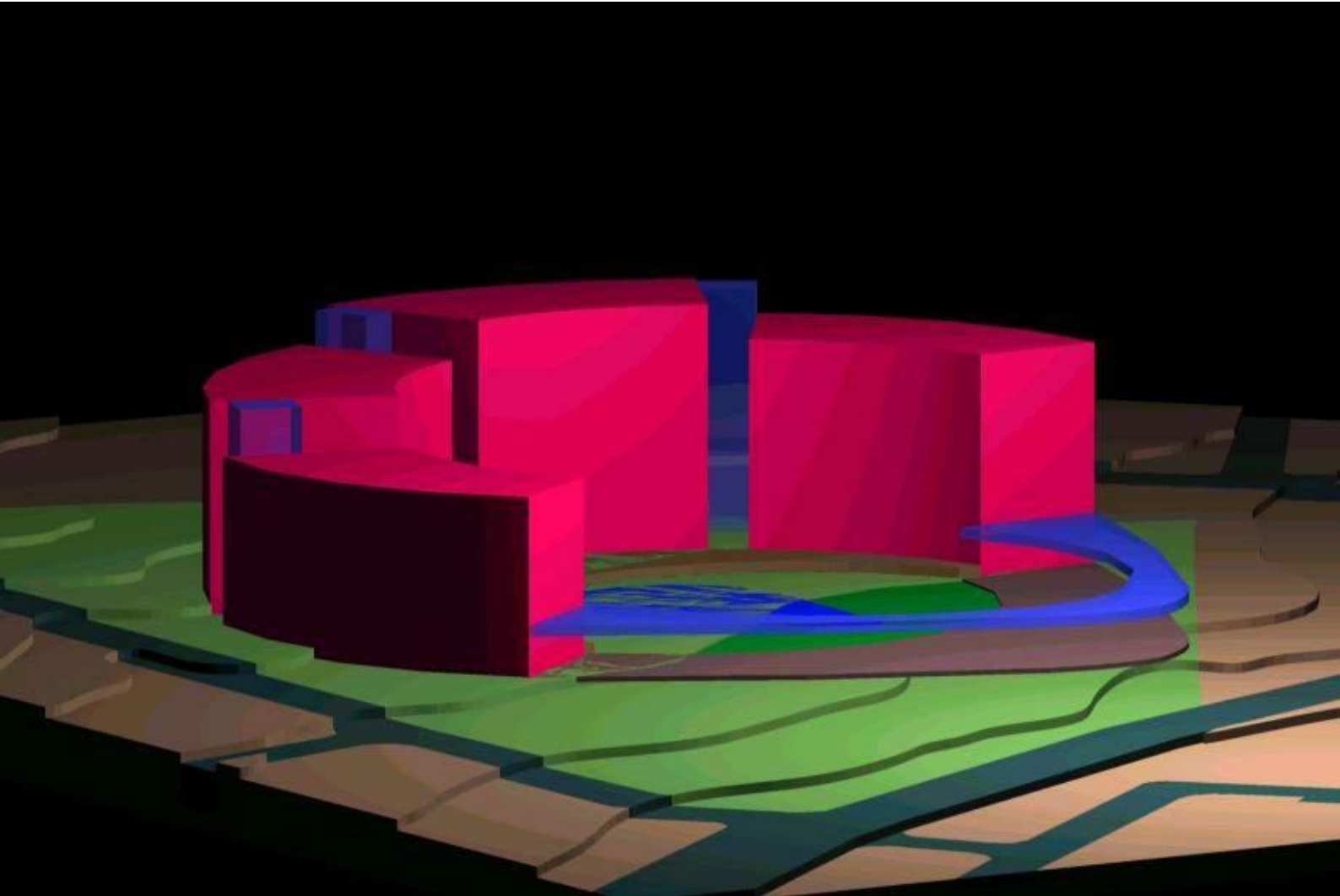

Following a highest and best use study, 23.000 sqm site was planned as 20.000 sqm of offices, 3400 sqm recreation, 21.500 sqm services and garage area during the brainstorming sessions with the client and the real estate marketing experts, the advantages and disadvantages of the project were discussed. The concept design was prepared based on the architectural program that was discussed and approved by all stakeholders.

The project has not been realized.